

### BS-CFM-600-IN06

In-hood 600 CFM  
Discharge: 6"



### BS-CFM-1200-IN12

In-hood 1200 CFM  
Discharge: 10" (Uses two blowers directed into a single plenum)



MH Models Only

All Other Models

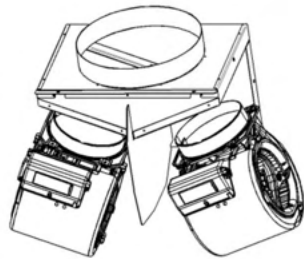
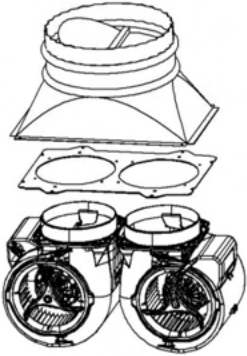

### SUPPLIER BENCH DATA FOR SINGLE BLOWER

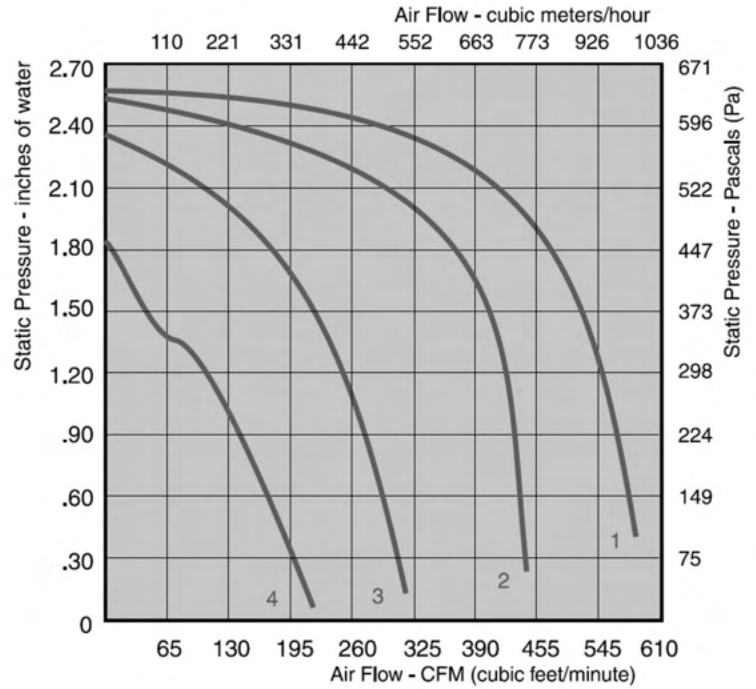

Controller Speed Setting	CFM @ 0	Curve	Voltage (V)	Power (W)	dBA
1	212	4	115	193	50
2	318	3	115	255	55
3	441	2	115	327	59
4 (Boost)	582	1	115	455	63