

**Prizer-Painter Stove Works
Technical Bulletin**

Date: July 2019

No: B-001

Model(s) All Models

Issue BlueStar Serial Plate Locations

Action Serial plate locations all refrigeration and cooking product

Built-in Refrigerator

Freestanding Refrigerator

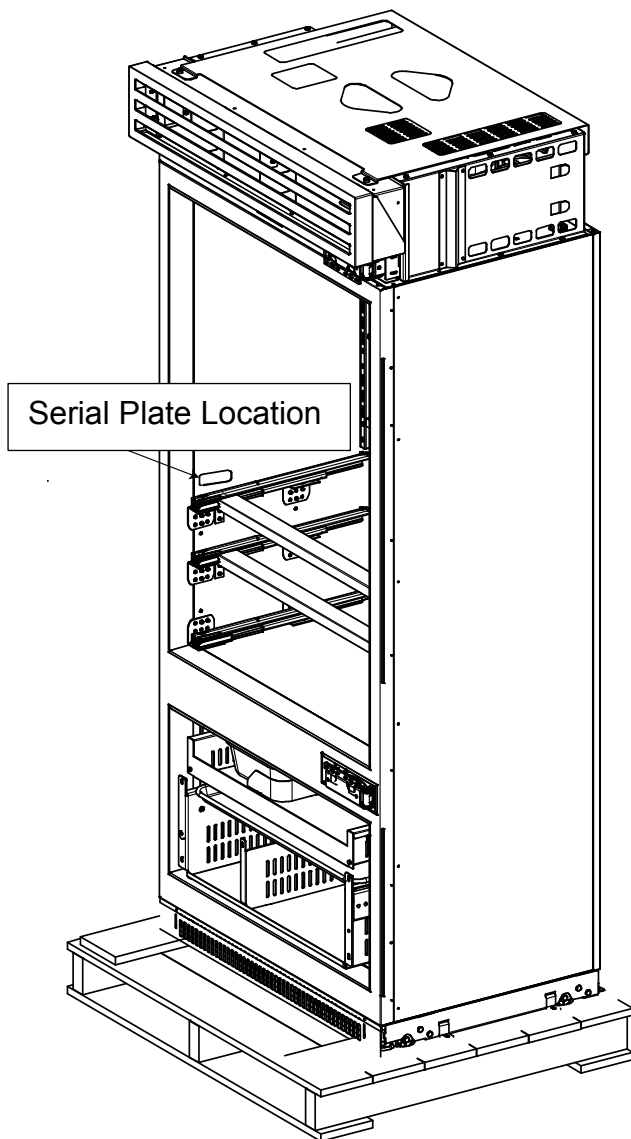

Pull out the full extension shelf. The serial plate is on the front left interior wall.

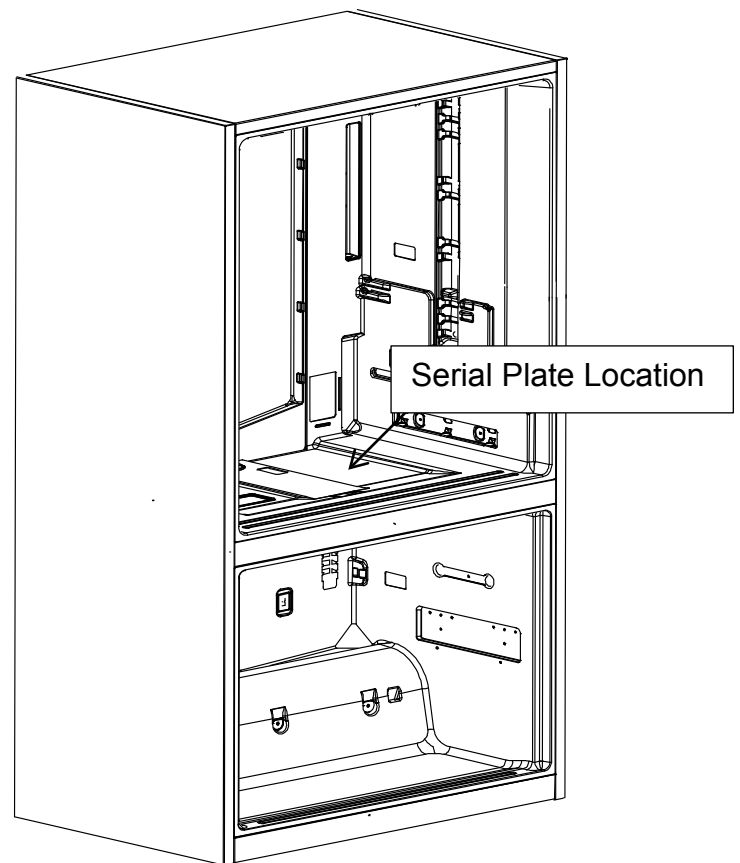

Pull out refrigerator full length deli drawer. The serial plate is located under the drawer.

Prizer-Painter Stove Works Technical Bulletin

Date: July 2019

No: B-001

Sealed Burner Range

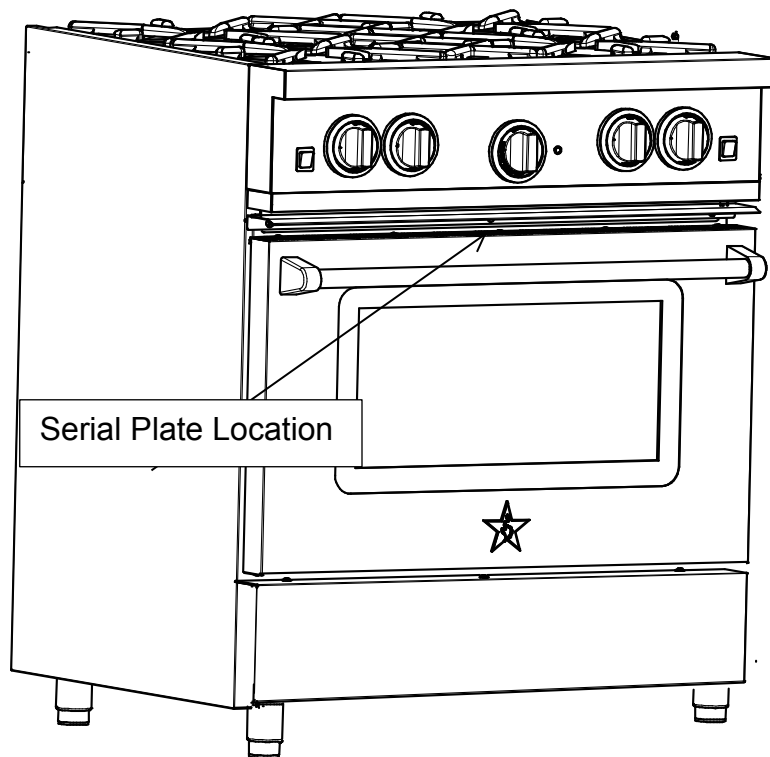

If serial plate is not under deflector, pull unit away from wall. Remove the back guard. The serial plate is under the burner bowl.

Open Burner Range or Rangetop

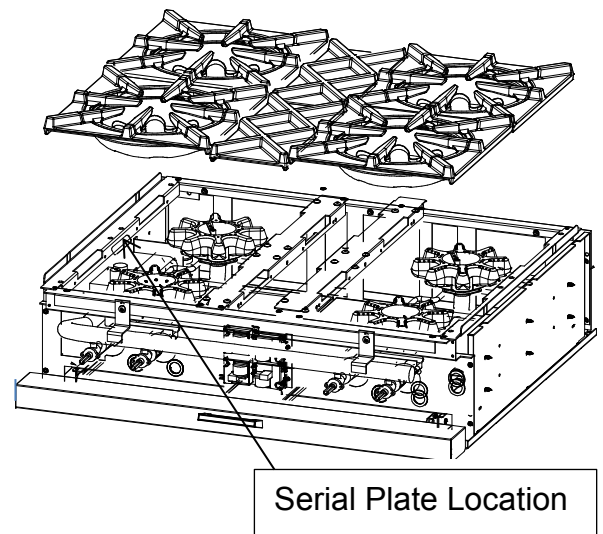

Remove the front left grate. The serial plate is on the left interior wall.

Prizer-Painter Stove Works

Technical Bulletin

Date: July 2019

No: B-001

Gas & Electric Wall Ovens

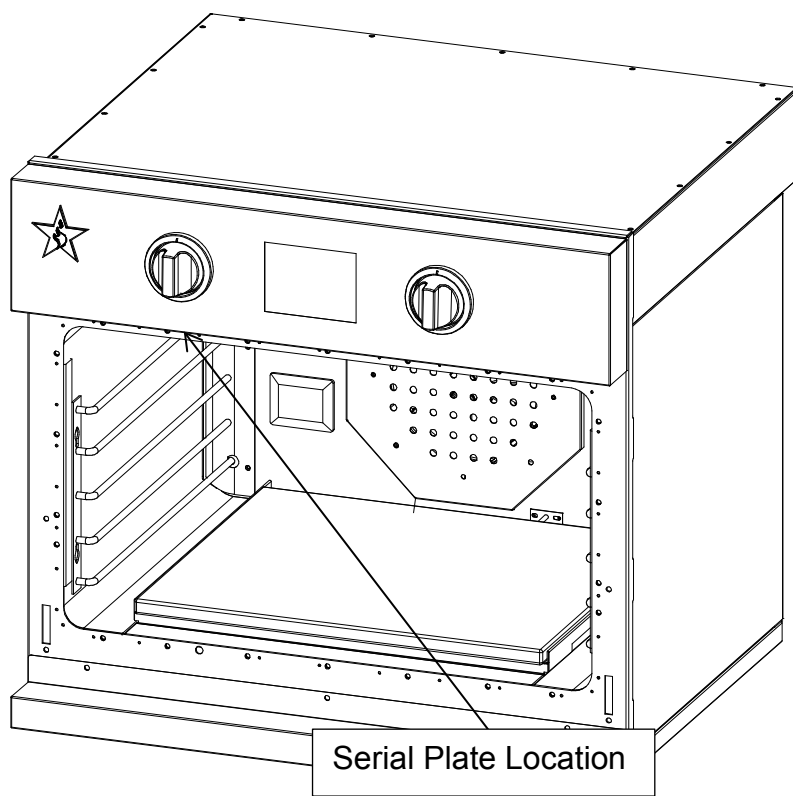

The serial plate is on the left underside of the control panel. If serial plate is not on the underside of control panel remove the control panel cover. The serial plate is on the left interior wall.

Induction Cooktop

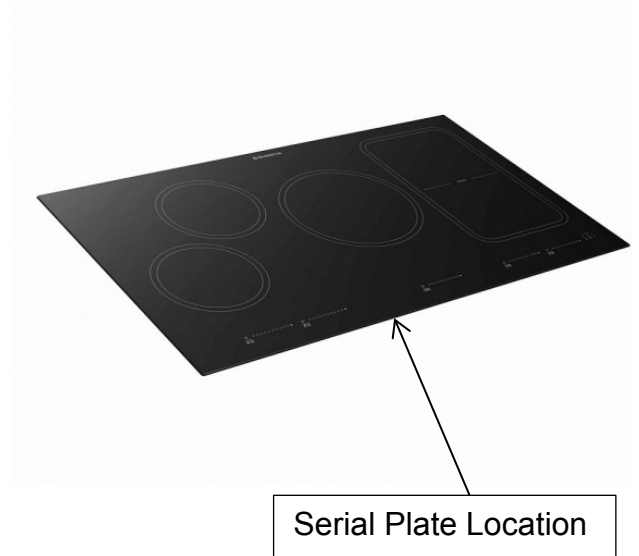

The serial plate is located under the cooktop in the front center.